

Model: **3739** **TRANSFER SHOWER FLOOR**

READ ALL INSTRUCTIONS CAREFULLY AND INSPECT PRODUCT FOR DAMAGE BEFORE STARTING YOUR INSTALLATION INCLUDED IN CARTON:

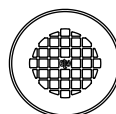
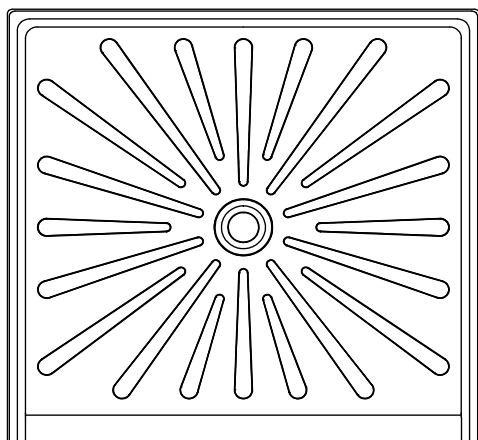

Instruction
Sheet

TOOLS AND MATERIALS REQUIRED FOR INSTALLATION:

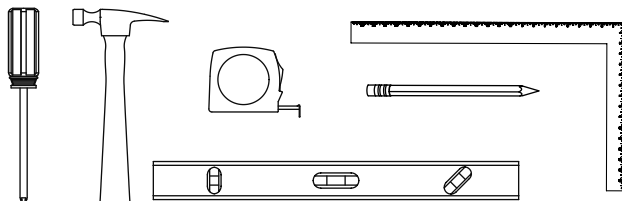

Deck Screws 3/4" long minimum

OR

Roofing Nail 1" long

• Pad (Roof felt, Landscape fabric or House wrap)

• OPTIONAL: Mortar Cement

• 1/4" Dowel Rod (For Drain Seal Installation)

ACCESSORIES (ORDER SEPARATELY)

Stainless Steel Grab Bars

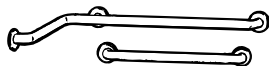

1½" Diameter

Part No.	Size	Type
390.301	24"	Straight
390.305	18"	Straight
390.306	36"	Straight
390.304	34" x 18"	Inside Corner

1¼" Diameter

Part No.	Size	Type
390.323	24"	Straight
390.324	36"	Straight

Pull-Down Shower Seats

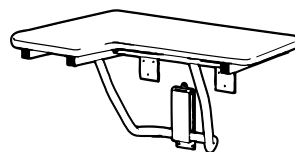

Part No.	Size	Type
390.401	26"	Right Hand
390.402	26"	Left Hand
390.403	32"	Right Hand
390.404	32"	Left Hand
390.409	26"	Straight
390.410	32"	Straight
390.413	23"	Straight

ROUGH-IN DIMENSIONS:

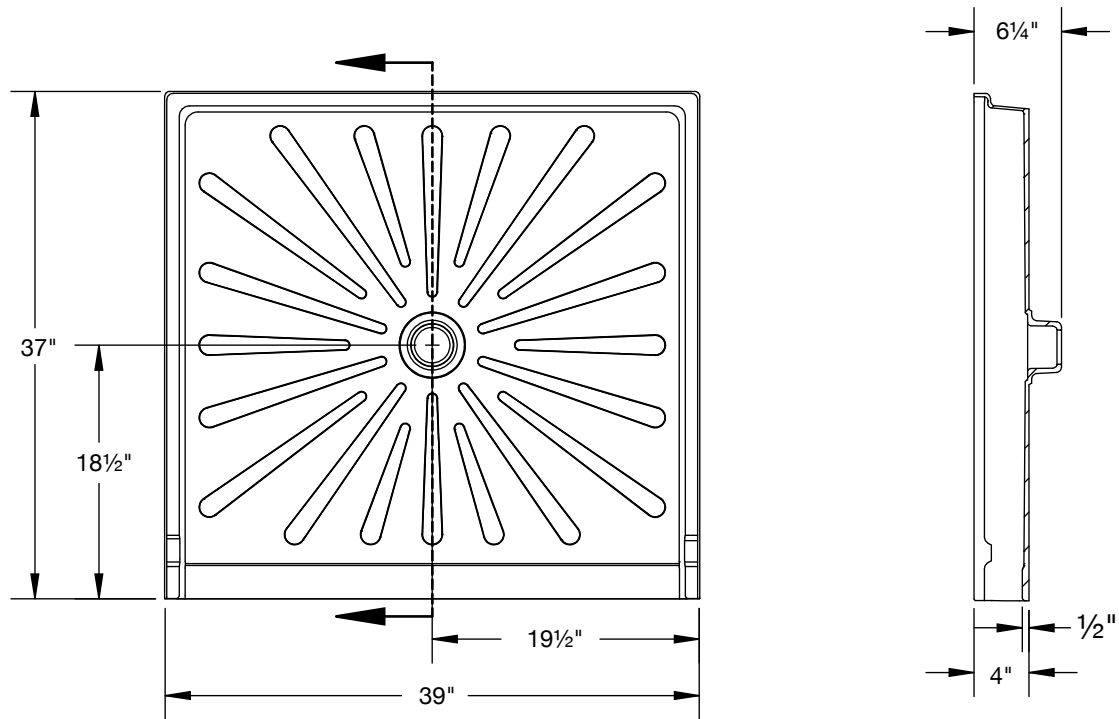

ALCOVE FRAMING:

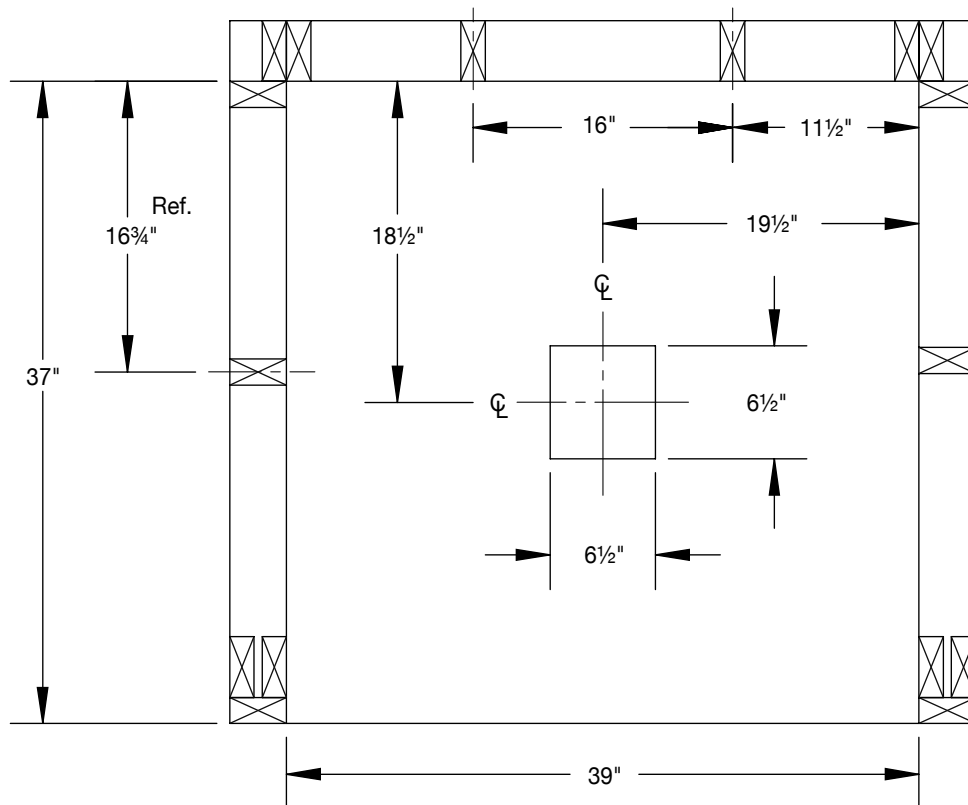

PREPARATION:

Before installing the Shower Base you will need to prepare the alcove area. Plan rough plumbing requirements (drain-venting-supply lines) at this time according to local building codes.

Additional bracing to support optional grab bars and or seat should be installed at this time. Refer to the accessory manufacturer's instructions for proper installation.

INSTALLATION:

STEP 1:

SUB-FLOOR PREPERATION

The Shower Base must be installed on a sub-floor. A one-piece section of plywood or OSB the same thickness as the surrounding sub-floor must be securely fastened in position so Shower Base is fully supported.

(Note: Use 2 1/2" deck screws to secure sub-floor). A 6 1/2" square opening will need to be cut in sub-floor (reference "ROUGH-IN" dimension) to accomodate shower floor integral drain body.

If Shower Base will be installed on a concrete/cement slab the 6 1/2" square opening will need to be a minimum of 2 1/2" deep.

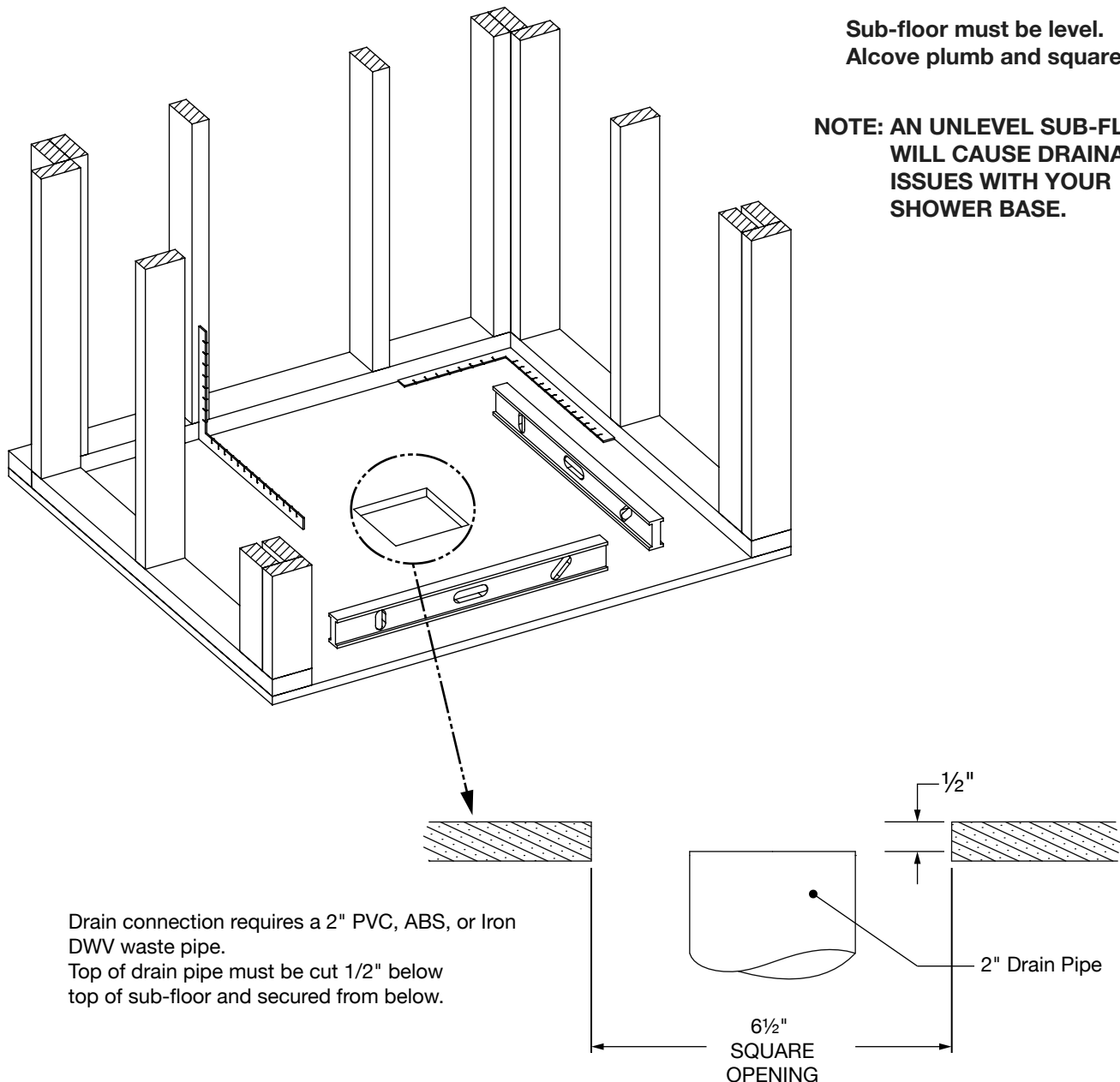

STEP 2:

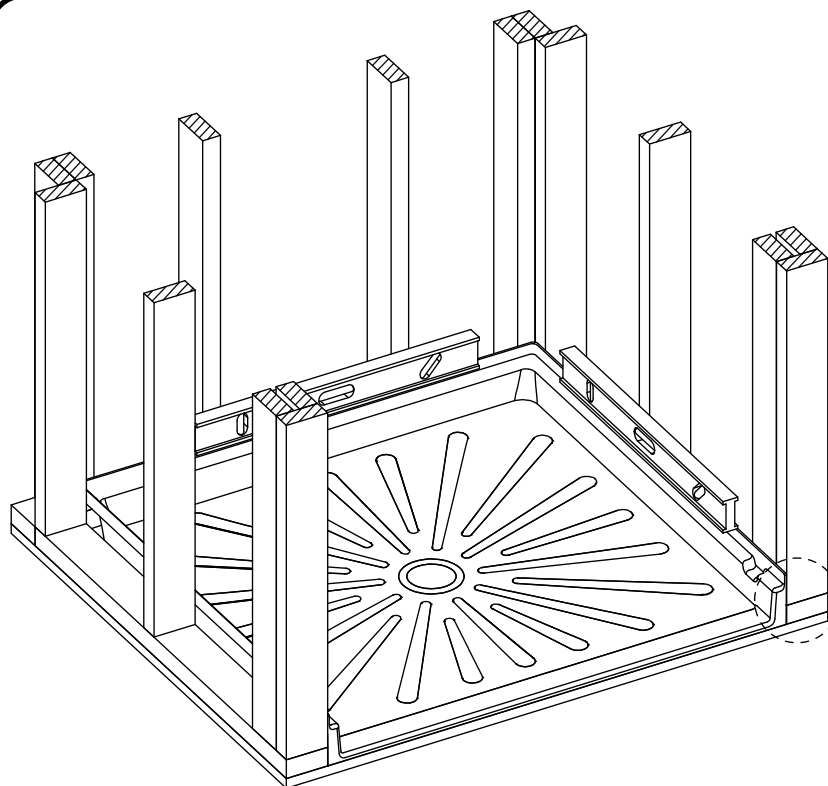

Set Shower Base into alcove and check for level condition. Level should be placed on top of tile flange as shown.

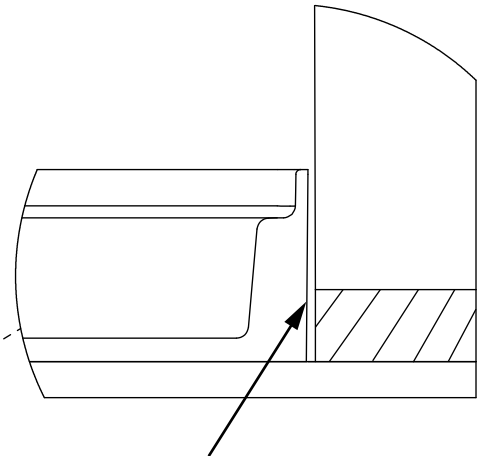

NOTE: At this time it is recommended to shim any gaps between studs and shower floor.

STEP 3:

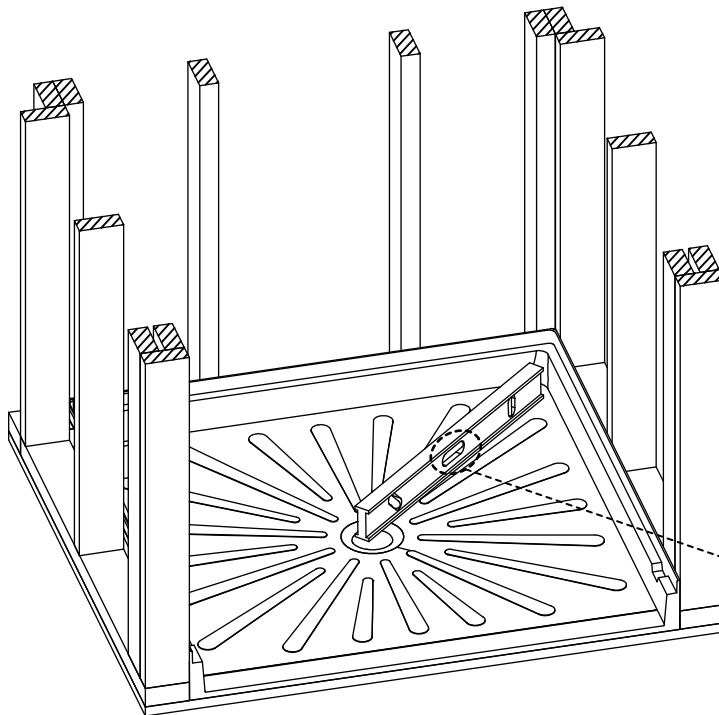

Place a level on the floor to ensure floor slope to drain. The bubble should be slightly off center.

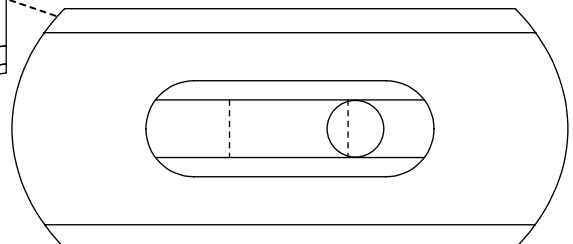

STEP 4:

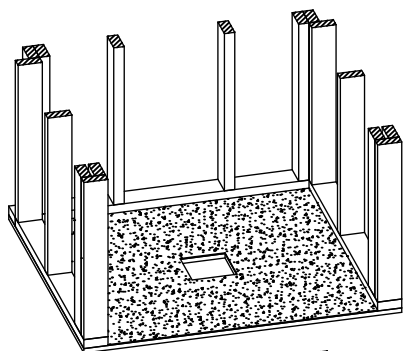

Remove shower base from alcove.
Install a felt pad onto sub-floor.
Be sure pad fills the whole area of alcove.

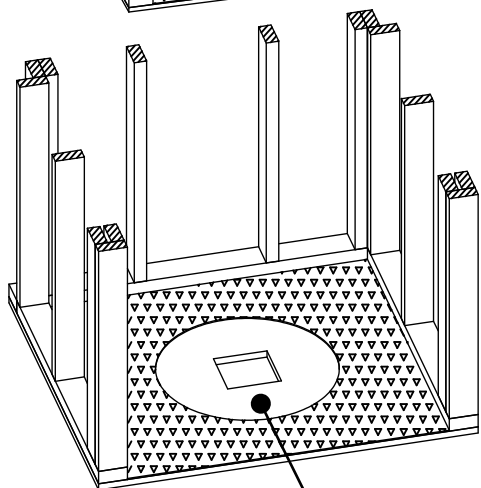

NO MORTAR IN THIS AREA

If a mortar bed is going to be used, you will notice a 20½" diameter flat circle on the bottom of the shower base around the drain area. DO NOT put any mortar into this area as it could cause the shower base to lift in that area and cause issues with water draining properly. Recheck level of the shower base. See steps 2 and 3.

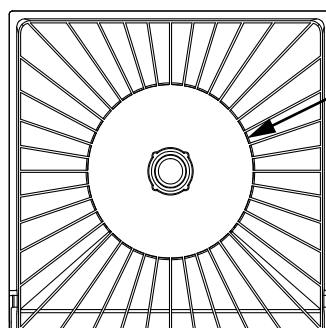

20½" Dia. Circle

SHOWER BASE BOTTOM

STEP 5:

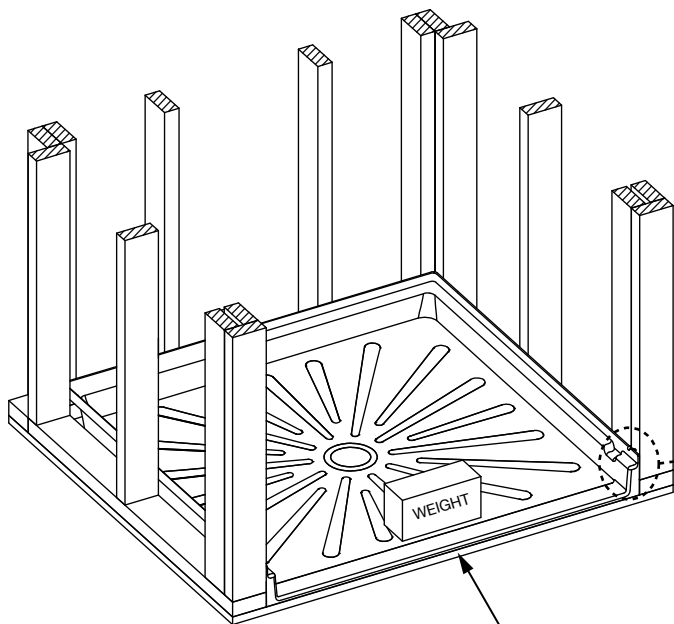

Reset Shower Base into alcove. The Shower Base can be retained in the alcove by installing large headed roofing nails over the tile flange on each stud. Or predrill 1/8" diameter holes in the tile flange and secure to studs using deck screws. Place a dab of silicone into holes before installing screws. Do not over-tighten screws.

NOTE: If a gap is noticeable between shower floor and the sub-floor, apply silicone adhesive under the treshold area of the shower base and apply a weight as shown. Then secure the shower base to the studs.

STEP 6:

Installing Drain Seal - Apply liquid soap to the inside and outside of Drain Seal. Place Drain Seal over waste pipe and push into drain cup. Using a hammer and 1/4" dia. dowel rod, tamp Drain Seal into place. Top of Drain Seal should be even with the top of the waste pipe when fully installed. Press Strainer into place.

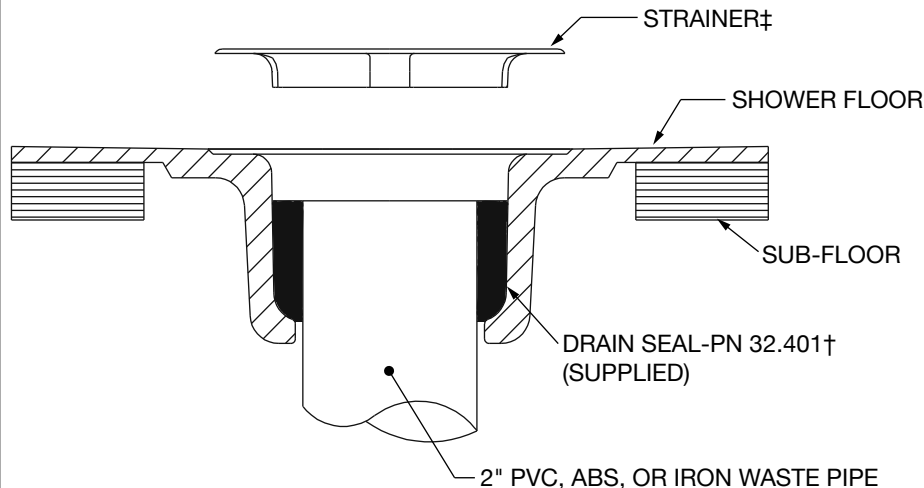

† Optional DRAIN SEALS are available:
PN 32.403 - 2" SOIL PIPE/CAST IRON
SERVICE WT. (NO HUB)

PN 32.404 - 2" COPPER PIPE, TYPE K, L, or M

PN 32.405 - 1½" PVC, ABS, or IRON PIPE

‡ Optional STRAINERS are available:
PN 34.301 - POLISHED STAINLESS STEEL

PN 42.326 - CHROME PLATED

PN 42.327 - GOLD PLATED

TYPICAL WALL INSTALLATION

TILE / SOLID SURFACE OR GLUED-ON WALL PANEL INSTALLATION DETAIL

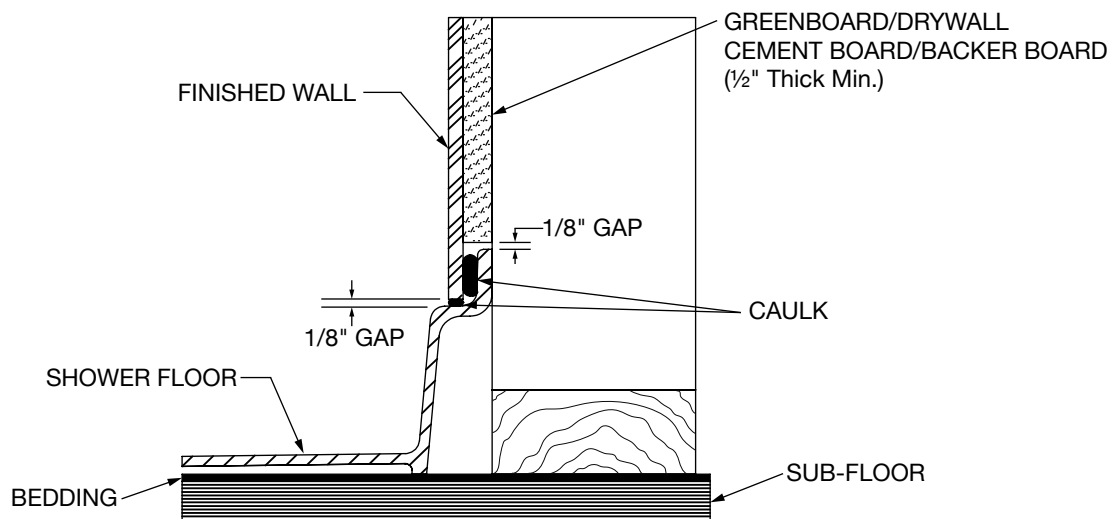

CARE & CLEANING

The surface of your MUSTEE SHOWER FLOOR may be cleaned with a mild soap solution in warm water using a soft cloth. When using a cleaner product, carefully read the label to ensure that the cleaner is safe for use on the material. Stubborn stains can be cleaned using "Soft Scrub"® by Clorox® or a powdered detergent such as "Spic-n-Span"®. Do not allow cleaners to sit or soak on the surface. Wipe surface clean and rinse completely with water immediately after cleaner application. Rinse and dry any overspray on nearby surfaces. Never use abrasive scouring powder or steel wool pads, as they will scratch the surface.

INSTALLATION QUESTIONS

Questions on the installation or missing parts, call 216-267-3100 or email customerservice@mustee.com for assistance.

Please have the installation manual available when calling.

DO NOT RETURN PRODUCT TO THE PLACE OF PURCHASE.

As a company committed to continuous improvement, the specifications in this installation manual are subject to change without notice.



Preferred by the "Pros"

SI-198 (02-24)

Patented and patents pending. Made and Printed in U.S.A.