



MUSTEE
Preferred by the "Pros"

63.600A Service Faucet



Design features:

- Heavy duty, rough brass, chrome plated
- Brass dual handle faucet (wall mount)
- Top reinforcing bar and pail hook on spout
- Eccentric inlets on 8" Centers
- Vacuum breaker

Code Accepted

Mustee service faucets meet or exceed performance requirements:

- CSA B125 (USA + Canada)

Specifications

Model No.	Color	UPC
63.600A	Chrome	6 71031 00277 8

Dimension	Length	Width	Height*
Overall	9 1/2"	10 5/8"	9 3/8"

*Height is from the screw holes of the Stabilizer Assembly to the center of the Inlet/Flange Assembly

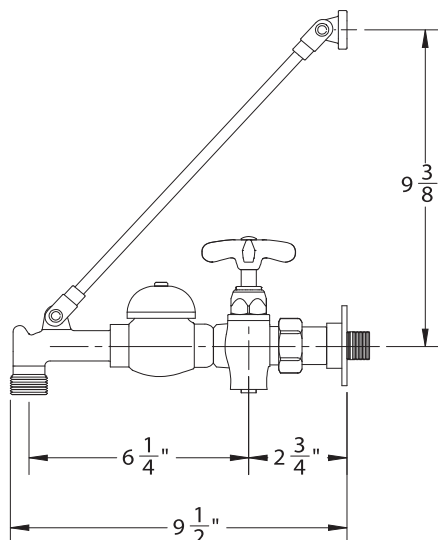
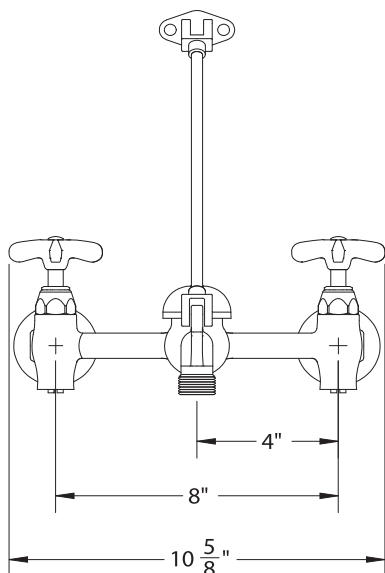

General: Chrome plated brass service sink faucet, 1/2" pipe eccentric inlets on 8" centers. Vacuum breaker integral stops, chrome plated (H&C) handles, 3/4" hose end spout with pail hook, top reinforcing bar and mounting bracket. Shall meet ANSI Specifications A112.1.1, Section 2.9 and A112.18.1M, CSA Listed. Install as shown on plans and in accordance with local codes.



MUSTEE

E.L. Mustee & Sons, Inc. • 5431 West 164th Street • Brook Park, OH 44142 • Phone: 216.267.3100 • Fax: 216.267.9997
E-mail: info@mustee.com • Web: www.mustee.com • Proudly made in the USA

Notice: Our continuous commitment to product improvement may result in changes to product specifications without notice.
Patents pending. Made and Printed in U.S.A.